

PHEW®

TRACKER

PHL-1000K (RC)

PACH-100N (AR)

English explanation

1. Precautions before use (2p)
2. How to Use AR Tracker and Problems (5p)
3. How to use the RC remote control and problems (9p)
4. Use of the application (14p)

1. Precautions before use (2p)

Regarding the Bluetooth communication distance

When using indoors by connecting APP ↔ PHEW®TRACKER

There is no problem with communication in one space. (Living room)

There is a ``wall'' between the space and the ``door''. (Communication disturbance)

It is recommended to use it in a specific space. In the case of Bluetooth communication, it is a communication standard optimized for short distance.

Reference

- Substances with low probability of interference: wood, glass, and most plastics
- Substances with medium probability of interference: water, brick, marble
- Materials with high possibility of interference: gypsum, concrete, bullet-proof glass (inner walls of buildings)-Substances that cannot be communicated: Metal (apartment door, door material of general house)

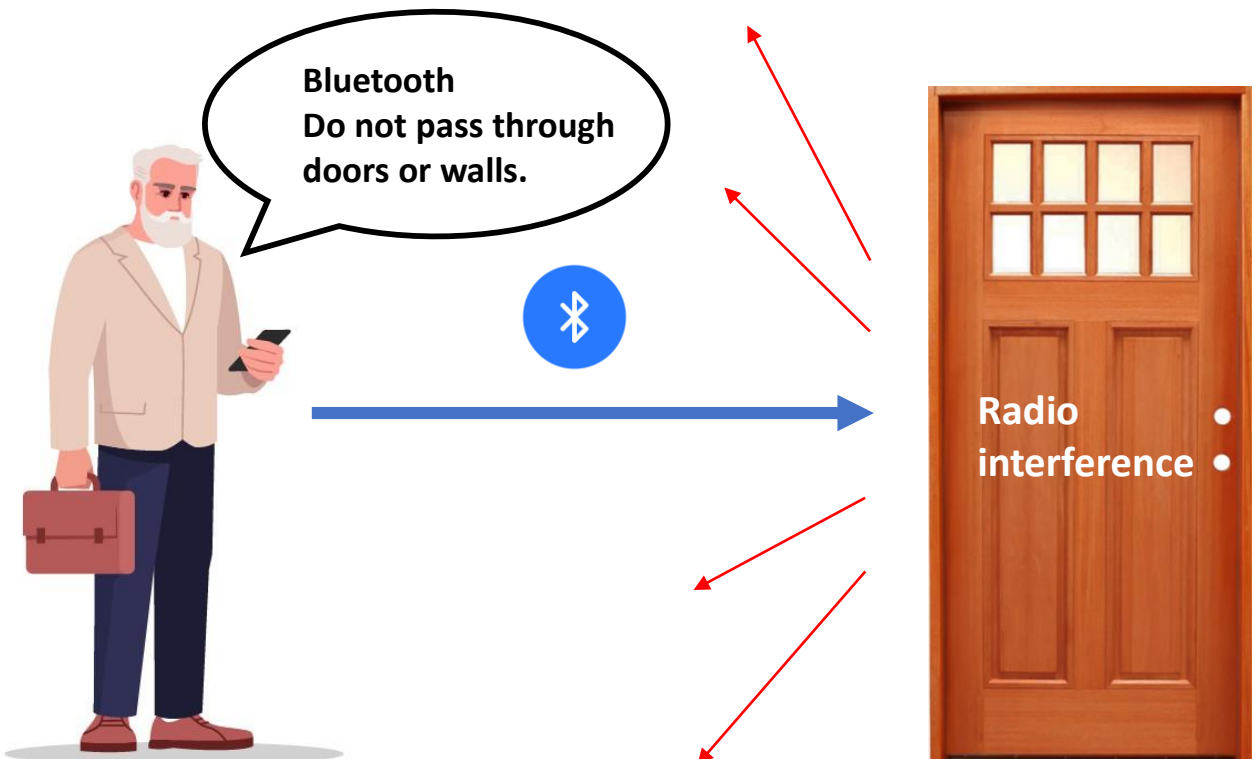



If the space you want to live or use is a two-story house, Communication between the second floor and the first floor may not work well.

Use in a spacious living room,
private office space
in your own room

Living room or
Use in the room

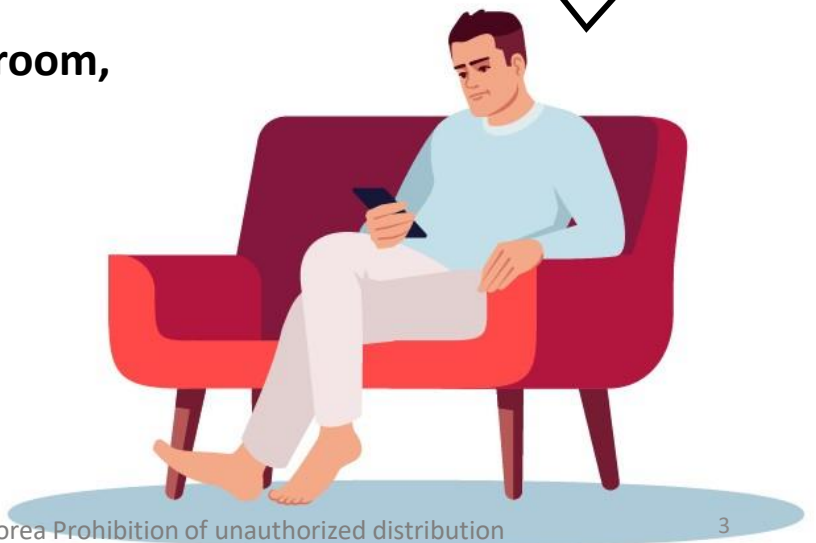

One-room type, convenient in the room



Monthly mansion, studio, detached house, apartment

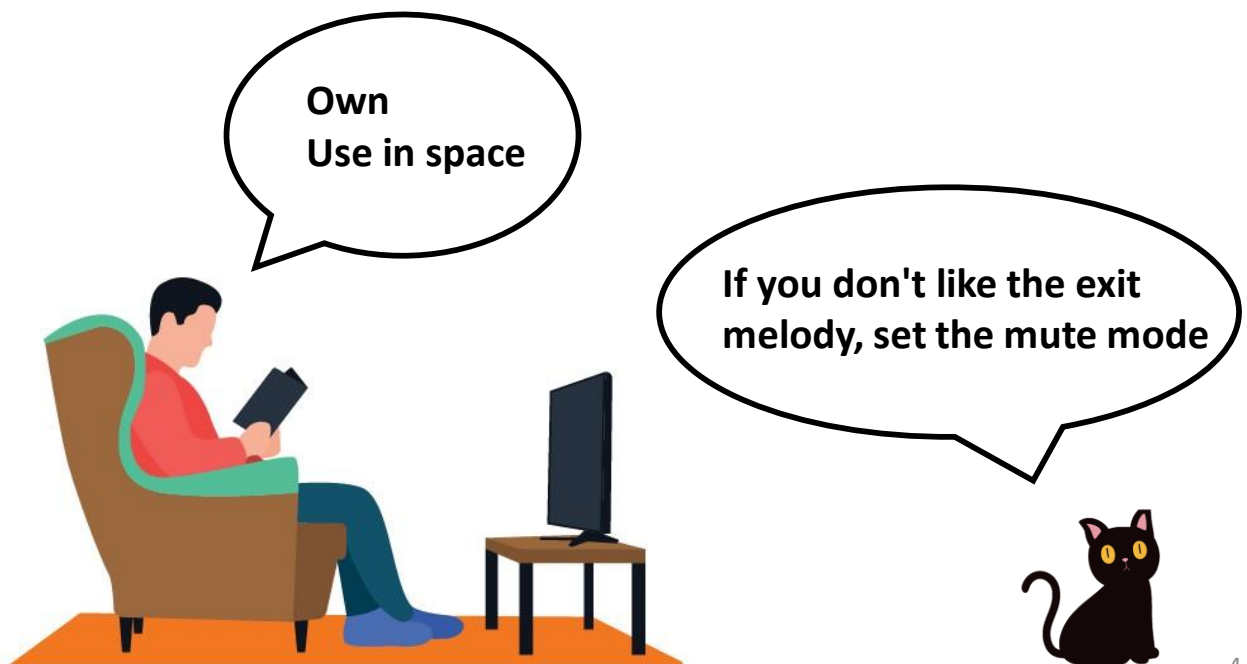

2. How to Use AR Tracker and Problems (1)

Let's call the smartphone → PHEW® Tracker.

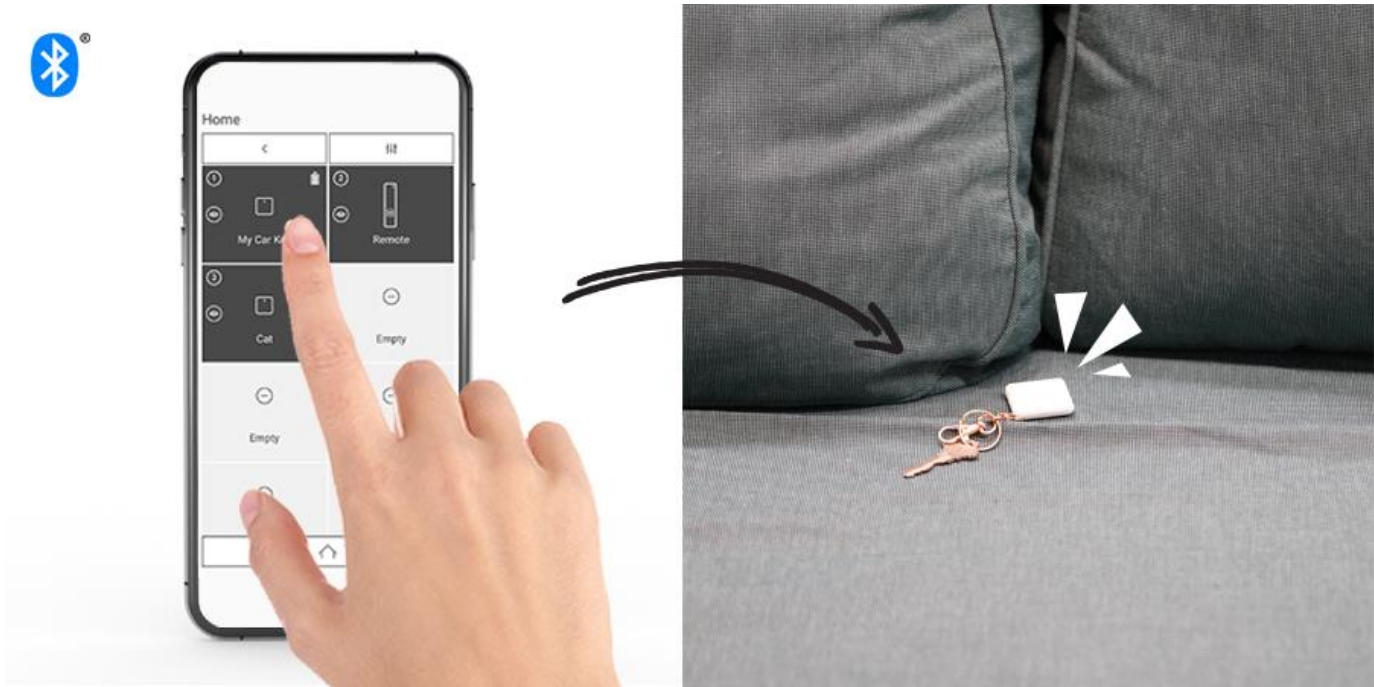

When the smartphone and the ↔ PHEW® tracker are within a communication distance
You can listen to the melody (buzzer sound) by calling Applications → PHEW® Tracker.

If communication between the Pew® tracker and the smartphone is interrupted,
within 10 seconds The melody set as a red alarm on the application screen occurs,
You can recognize the loss.

※ A place with a good view without obstacles, about 10-50m from about 10-50m on a flat ground

★ I really don't know how to do it! Inquiry by e-mail

2. How to Use AR Tracker and Problems (2)

From PHEW® Tracker → Find your smartphone.



When you are in a hurry to go outside!

Your smartphone goes unnoticed! In that case, don't rush

Double-click the PHEW® Tracker button twice.

We will tell you where your smartphone is ringing.

The melody lasts about 3 minutes,

The sound stops when you touch the blue flashing slot.

The melody of the smartphone can be changed in the settings, Volume can be adjusted.

Please check on the settings screen

★ I really don't know how to do it! Inquiry by e-mail

2. How to Use AR Tracker and Problems (3)

To turn off the sound, → Please press the mute button ~ (1 time)

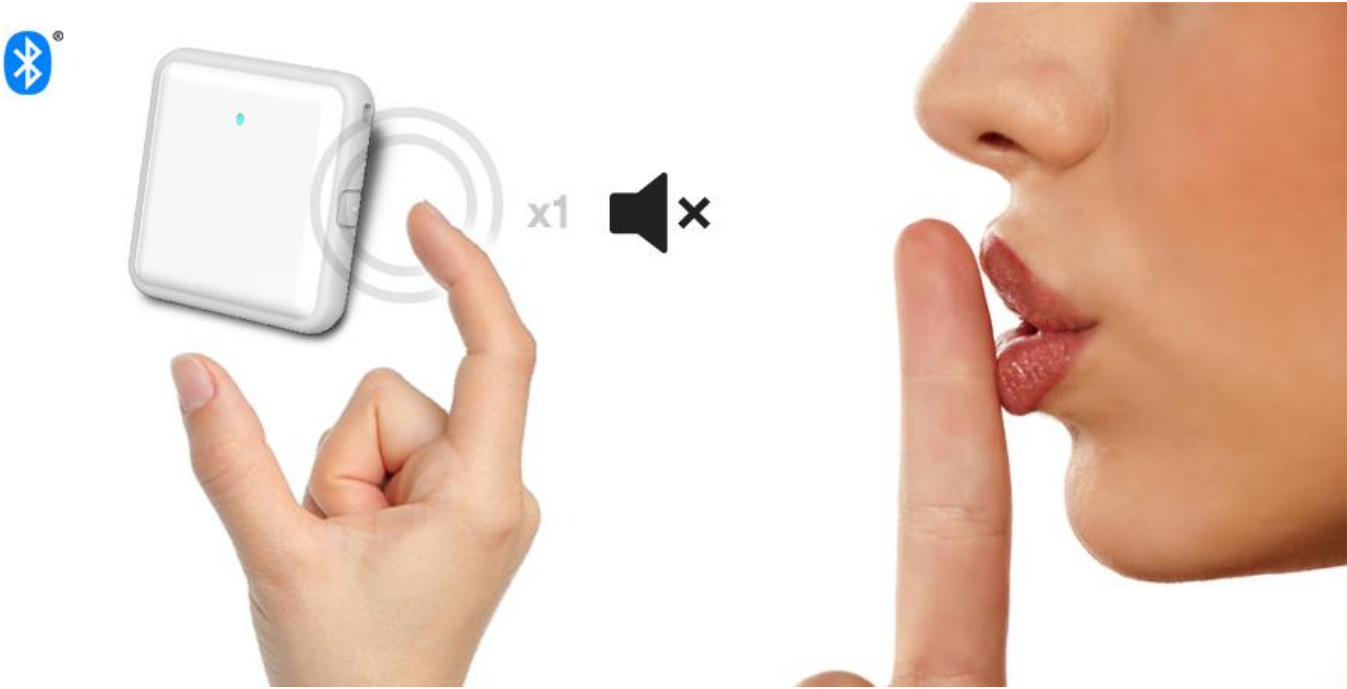

In addition to the basic features of finding lost items, a single push of the Pew® Tracker side button

① Buzzer release ▼ ② Buzzer sound on ↗ ③ Buzzer release ▼ This is a routine and repeats with a melody.

Some functions assigned to the Pew® Tracker button will be O.T.A (wireless update) in the future.

If the application does not ring the tracker You may have set it to mute mode. (Please check)

★ I really don't know how to do it! Inquiry by e-mail

2. How to Use AR Tracker and Problems (4)

Use Panasonic for mercury batteries



If you use a different brand of battery, the power may not turn on or turn off.

Please purchase and use Panasonic batteries at convenience stores, etc.

When the battery is low, the tracker beeps briefly and repeatedly.

Do not use the product in water (IP32)

When attaching the bezel, be sure to assemble (attach) it according to the strap hole.

Please remove the battery safety film when using for the first time if inserted without removal, the product will not turn on.

★ I really don't know how to do it! Inquiry by e-mail

3. How to use the RC remote control and problems

Use after USB charging is complete

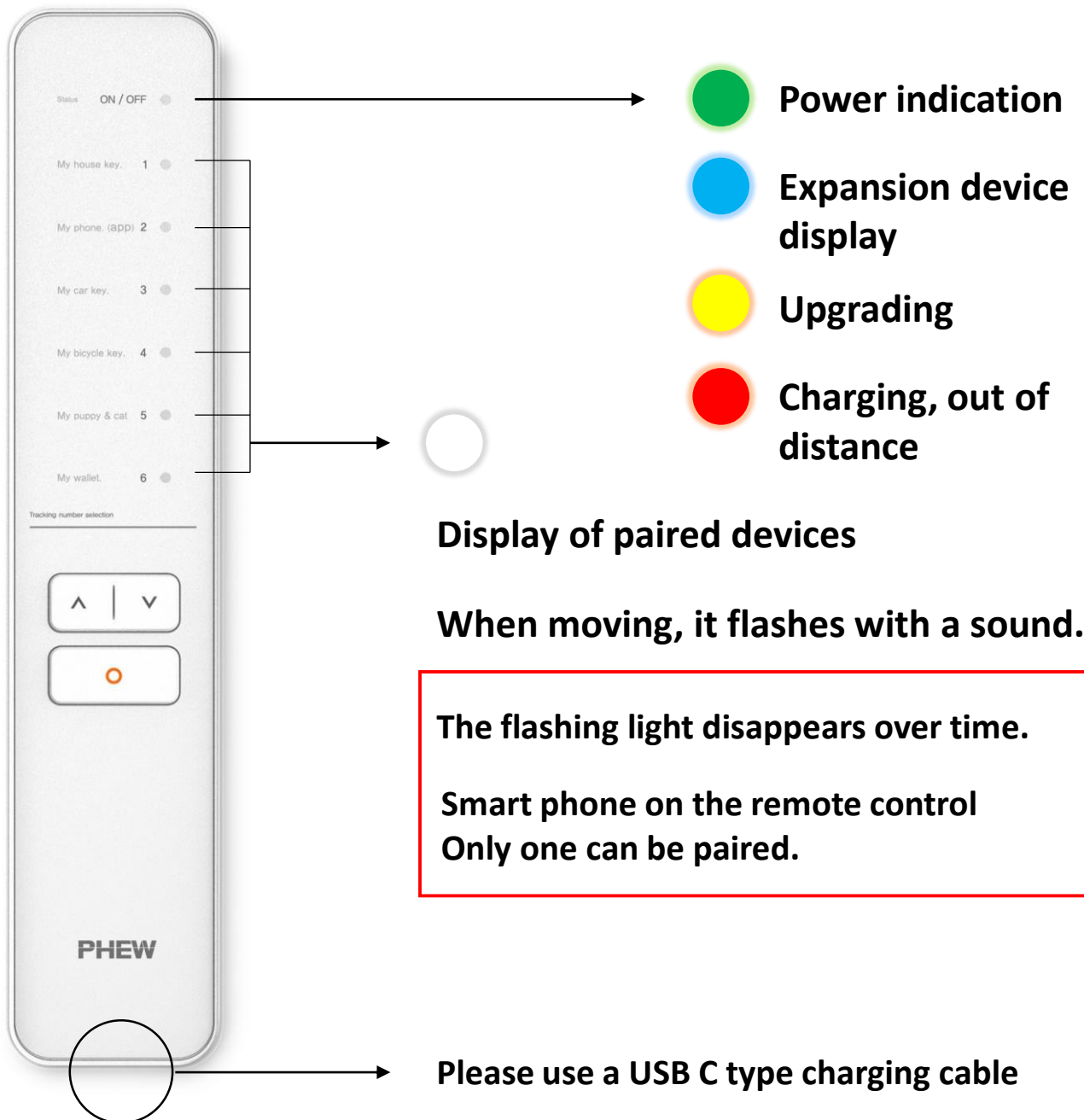

★ I really don't know how to do it! Inquiry by e-mail

3. How to use the RC remote control and problems

Comes with two protective films.

The devices used are shown as a few examples.

The material of the guide film is PET.

A film is attached to prevent contamination of the front part.

The material of the protective film is PVC.

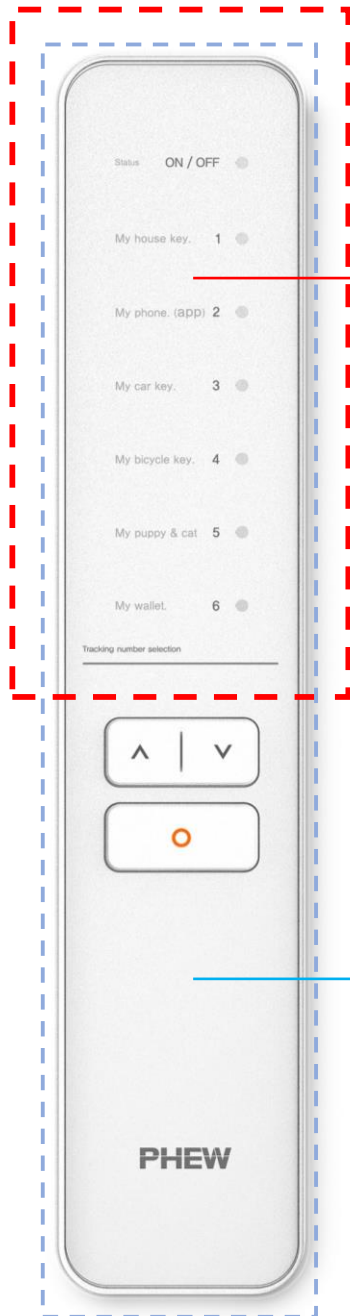

★ I really don't know how to do it! Inquiry by e-mail

3. How to use the RC remote control and problems

Use after USB charging is complete

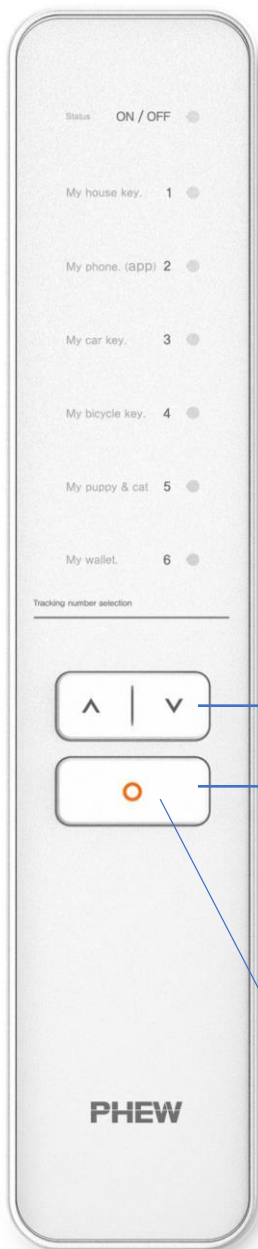

2

To desired slots 1 to 6 Use the
(Up / Down) key to move.

1

Turn on the power (press to set)

3

With the PHEW Tracker turned
on, Press the O button
Pairing is complete.

★ I really don't know how to do it! Inquiry by e-mail

3. How to use the RC remote control and problems

I want to call all paired trackers instead of looking for them one by one

1

With the PHEW Tracker paired
Press the side key once in the order of
123456 It is called automatically.

2

Press and hold the side key It starts again
with a melody. (reset)



★ I really don't know how to do it! Inquiry by e-mail

3. How to use the RC remote control and problems

Ah! The remote control suddenly stops working.

Ah! Initialization does not work

Ah! The power lamp keeps lighting red.

Ah! The product has stopped!

Put the pin all the way and press it
3-5 times It will be reset again.

Please be sure to put it in hole 1



★ I really don't know how to do it! Inquiry by e-mail

4. Use of the application (1)

Google Play Store, Apple's App Store Search for PHEW TRACKER
And download and install

(Caution) When installing, all allow, all agree, please



PHEW TRACKER

★ I don't know how to search!

Google Play Store Search and Download

Apple searches and downloads from the App Store

4. Use of the application (2)

After installation is complete, if you touch the appThe following screen appears.

※ It is a free application. Use it comfortably

PHEW Tracker
アプリを起動してください



4. Use of the application (3)

Please select Korean

Note 1) You can change it later in the language setting.

Note 2) When the language is changed, the paired devices are temporarily disconnected.

Please select your language

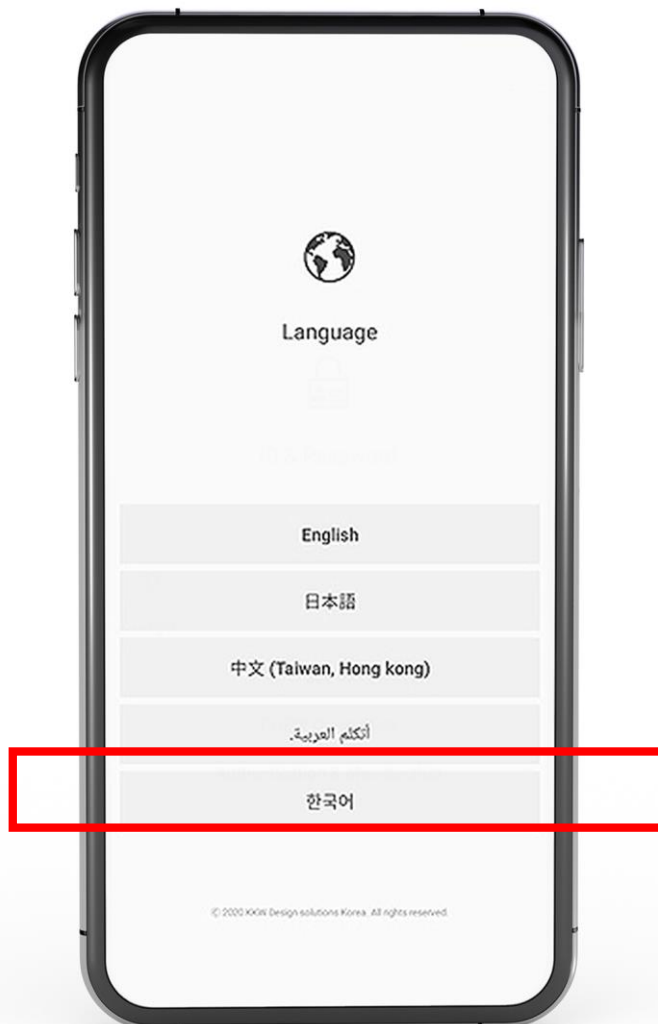

★ Select Korean

4. Use of the application (4)

You can use it without registering as a member.

Note 1) Only members are covered by the repair warranty.

Note 2) Please verify the QR code of the enclosed warranty.

Please register as a member

You can use it without registering as a member.

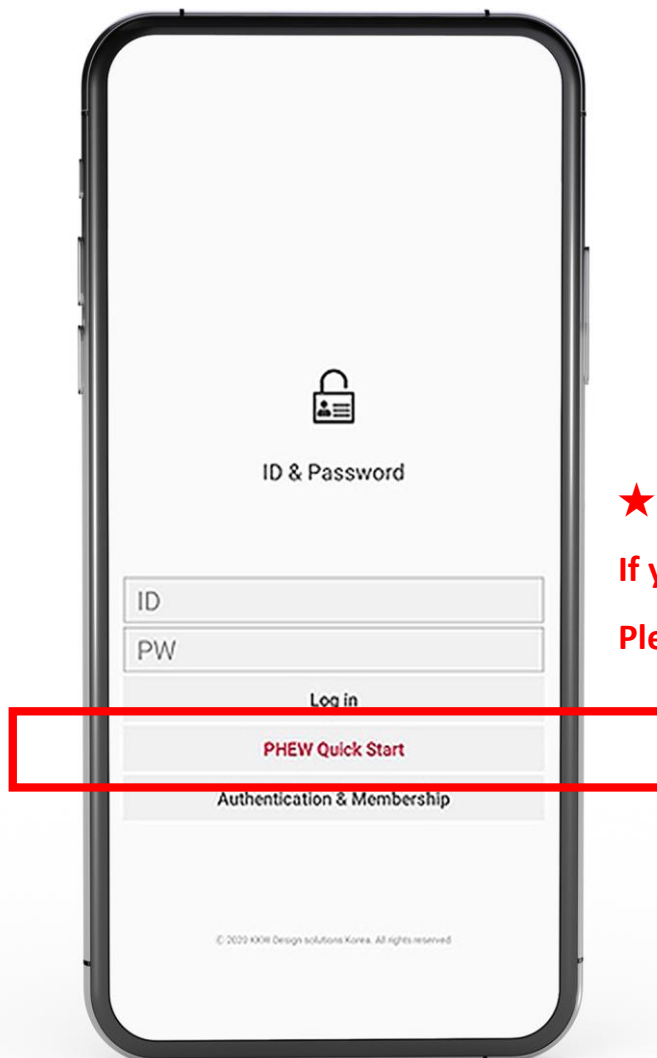

★ **Membership**

If you are bothered

Please select a quick start

4. Use of the application (5)

With the PHEW Tracker turned on, Touch an empty space (slot)

For the remote control, press the O button on the number you want to pair with When the green light flashes then you can pair.

Please touch the empty space

Turn on the Pew Tracker first

1



★ Press and hold to power on

2

★ Please touch the empty space

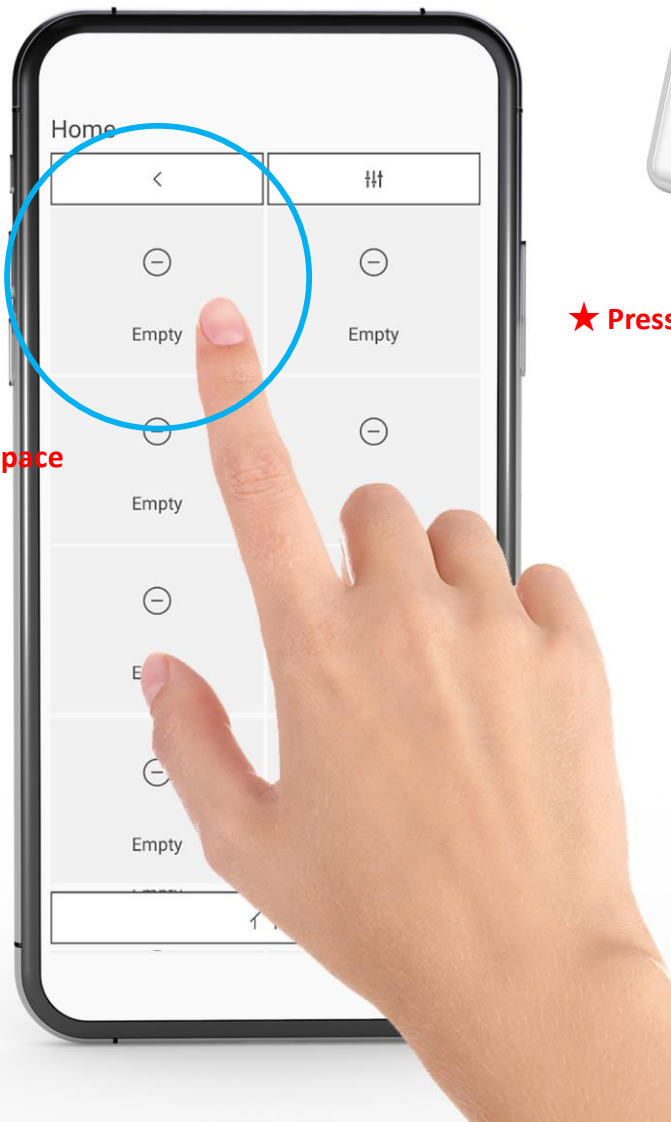

4. Use of the application (6)

Automatically when you touch the pop-up
(ID)Pairing is completed within 10 seconds.

Touch the device ID on the pop-up screen

Pairing is automatically completed within 10 seconds.

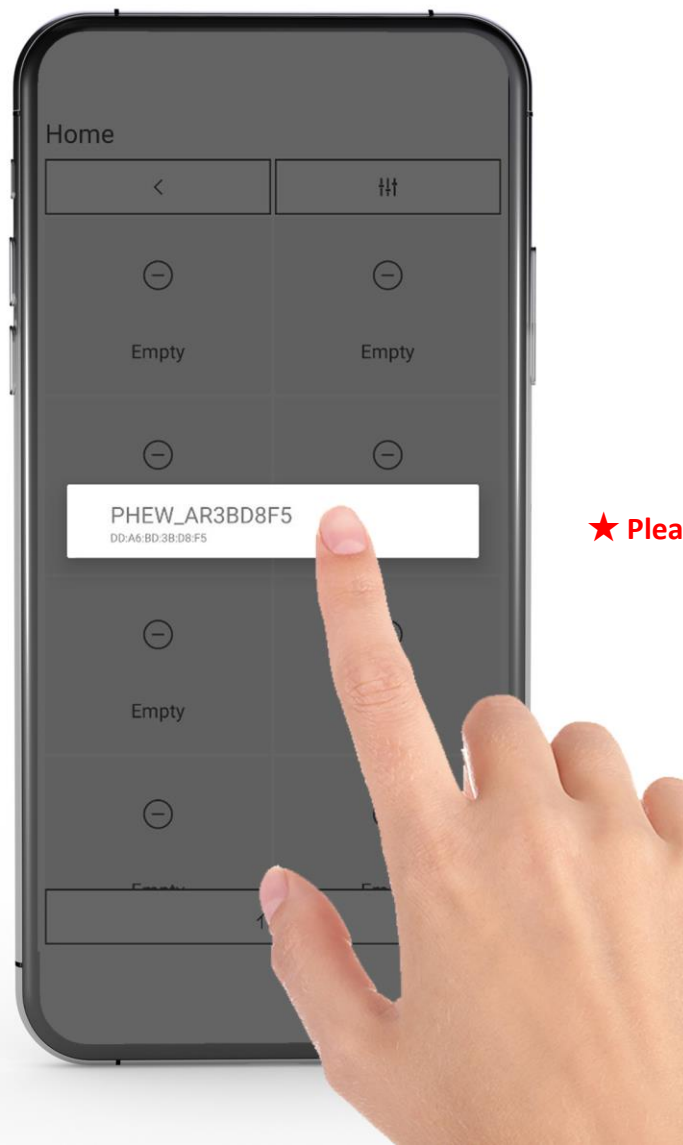

4. Use of the application (7)

This is the screen where pairing is completed. To delete, press and hold the slot to reveal the X button.

Touching the (X) deletes the pairing.

Pairing with the PHEW device is complete.

Name and name can be changed, and call is possible.

Name change is possible



Note) Cats, car keys,
dogs, wallets, bicycles

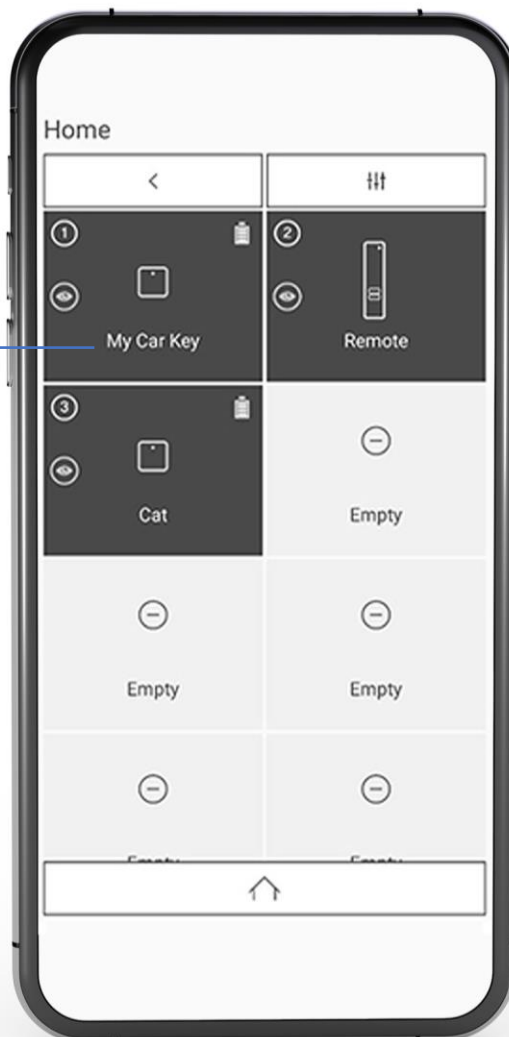

4. Use of the application (8)

Various settings/settings can be made on the setting screen.

Description of each name and function on the setting screen

Language, melody change, mute, usage, homepage, license registration,
Upgrade function of PHEW devices

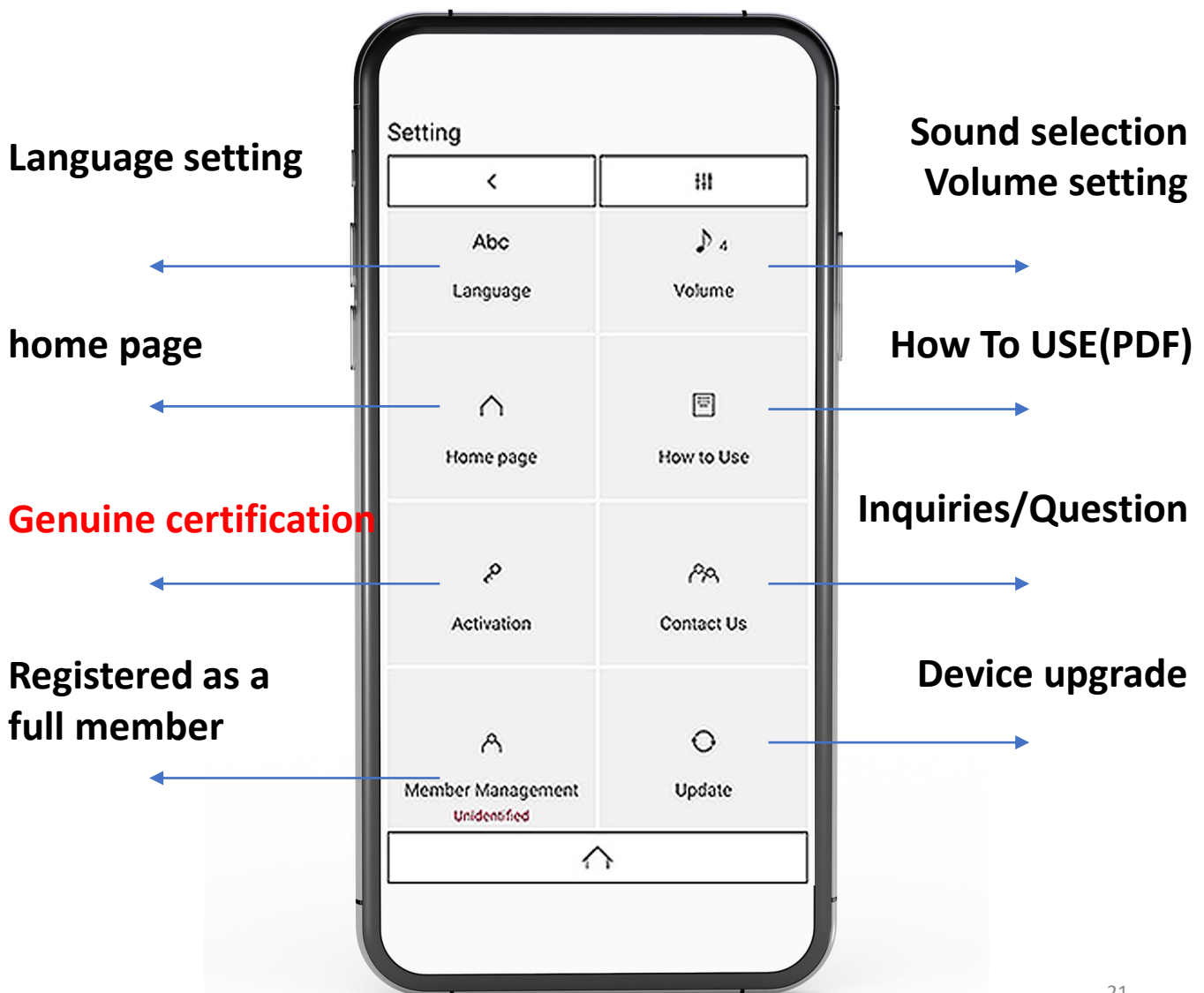

4. Use of the application (9)

QR authentication with genuine card enclosed inside the purchased product (important)

Caution) Never lose a genuine card

License authentication is automatically registered by verifying the QR code on the enclosed warranty card.

Be sure to store it separately for AS (must! needed)



4. Use of the application (10)

If the distance is lost or lost, the coordinate time of the last location is displayed.

I lost an important product I paired with!

I want to know where

I lost it due to a distance deviation notification!

The battery of the product is gone, so communication with the app is cut off.

If you touch the GPS icon of the slot, it is displayed on the Google Map.

Lost, lost
communicationYear,
month, day, time display

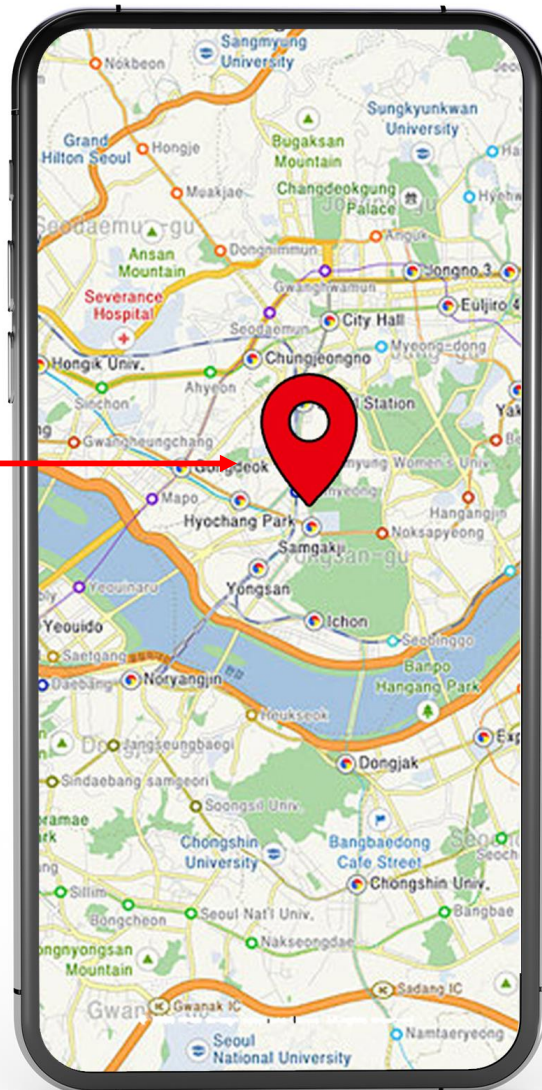



KKW Design®
Solutions
Korea

**You think there is a problem with the product you purchased
I really don't know how to use it. Those who do**



We will respond kindly.

info@pnew.shop